

Note: Sanitary Sewer Layout is Based on City of Ithaca Water and Sewer Department, Drawing S-17.

Legend

- ▼ Soil Vapor Sampling Location (Approximate)
- Manhole Sample Location (Dry Weather Air Sample)
- Sanitary Sewer and Laterals
- Soil Vapor Location Not Completed Due to Shallow Bedrock Refusal or Utility Conflict
- ▼ Proposed Soil Vapor Sampling Location Over Sanitary Sewer
- Proposed Soil Vapor Sampling Location Along Sewer Lateral
- Proposed Soil Vapor Sampling Location Over Fractured Bedrock

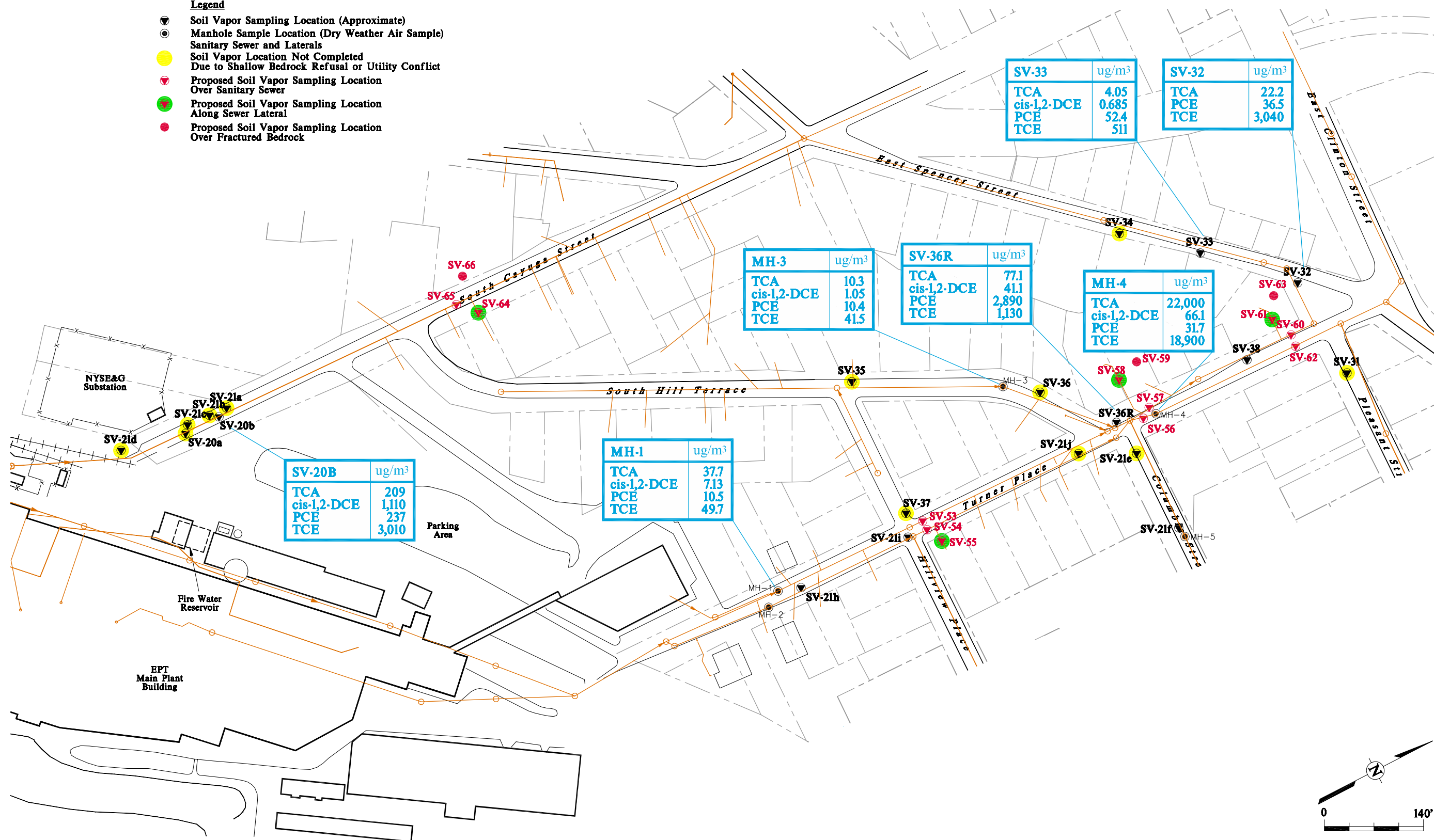

SV-20B	ug/m ³
TCA	209
cis-1,2-DCE	1,110
PCE	237
TCE	3,010

MH-1	ug/m ³
TCA	37.7
cis-1,2-DCE	7.13
PCE	10.5
TCE	49.7

MH-3	ug/m ³
TCA	10.3
cis-1,2-DCE	1.05
PCE	10.4
TCE	41.5

SV-36R	ug/m ³
TCA	77.1
cis-1,2-DCE	41.1
PCE	2,890
TCE	1,130

SV-33	ug/m ³
TCA	4.05
cis-1,2-DCE	0.685
PCE	52.4
TCE	511

SV-32	ug/m ³
TCA	22.2
PCE	36.5
TCE	3,040

MH-4	ug/m ³
TCA	22,000
cis-1,2-DCE	66.1
PCE	31.7
TCE	18,900

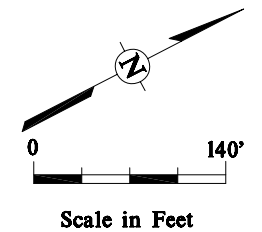

Drawn By: EGC
 Checked:
 Approved:
 DWG Name: 127491315

EMERSON POWER TRANSMISSION
 ITHACA, NEW YORK
 PREPARED FOR
 EMERSON POWER TRANSMISSION

Figure 15
 PROPOSED ADDITIONAL
 SOIL VAPOR POINT LOCATIONS

