

Fire Water Reservoir Section - Directional Boring Detail

- Notes:
- EXB-08 Groundwater Sample Collected at 82.25' btoc, Which Corresponds to a Depth of 72 Feet bgs.
 - Groundwater Results Reported in ug/L.

Legend
 Existing Monitoring Well
 New Well/Exploratory Boring Location

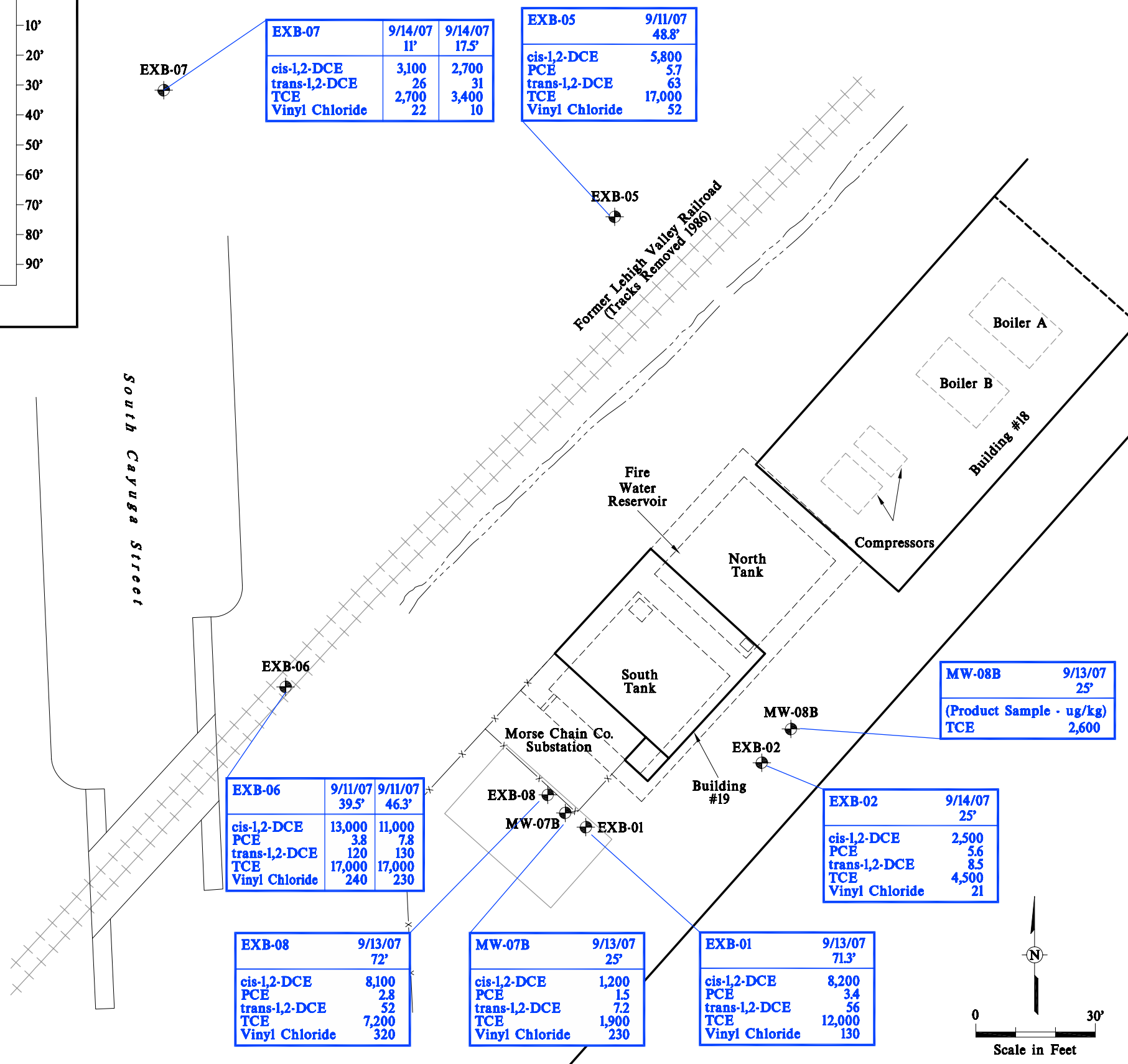

EXB-07	9/14/07 11'	9/14/07 17.5'
cis-1,2-DCE	3,100	2,700
trans-1,2-DCE	26	31
TCE	2,700	3,400
Vinyl Chloride	22	10

EXB-05	9/11/07 48.8'
cis-1,2-DCE	5,800
PCE	5.7
trans-1,2-DCE	63
TCE	17,000
Vinyl Chloride	52

EXB-06	9/11/07 39.5'	9/11/07 46.3'
cis-1,2-DCE	13,000	11,000
PCE	3.8	7.8
trans-1,2-DCE	120	130
TCE	17,000	17,000
Vinyl Chloride	240	230

EXB-08	9/13/07 72'
cis-1,2-DCE	8,100
PCE	2.8
trans-1,2-DCE	52
TCE	7,200
Vinyl Chloride	320

MW-07B	9/13/07 25'
cis-1,2-DCE	1,200
PCE	1.5
trans-1,2-DCE	7.2
TCE	1,900
Vinyl Chloride	230

EXB-01	9/13/07 71.3'
cis-1,2-DCE	8,200
PCE	3.4
trans-1,2-DCE	56
TCE	12,000
Vinyl Chloride	130

EXB-02	9/14/07 25'
cis-1,2-DCE	2,500
PCE	5.6
trans-1,2-DCE	8.5
TCE	4,500
Vinyl Chloride	21

MW-08B	9/13/07 25'
(Product Sample - ug/kg)	
TCE	2,600

Drawn By: EGC
 Checked:
 Approved:
 DWG Name: 127491294

EMERSON POWER TRANSMISSION
 ITHACA, NEW YORK
 PREPARED FOR
 EMERSON POWER TRANSMISSION

Figure 9
 FIRE WATER RESERVOIR
 GROUNDWATER SAMPLING RESULTS

