

**SITE LOCATION
SCALE**

INDEX OF DRAWINGS

<u>DRAWING NUMBER</u>	<u>SHEET NUMBER</u>	<u>DESCRIPTION</u>
00003197-003	1	TITLE SHEET
00003197-004	2	SITE PLAN
00003197-005	3	PRE-DESIGN VACUUM EXCAVATION
00003197-006	4	ROAD AND SIDEWALK CLOSURE PLAN
00003197-005	5	300-FOOT VENTING SYSTEM LAYOUT
00003197-007	6	EAST SPENCER STREET SEWER LINE RELOCATION
00003197-009	7	SITE WORK DETAILS
00003197-009	8	MANHOLE CONNECTION DETAILS

**OPERABLE UNIT NO. 3
300-FOOT VENTING SYSTEM
DESIGN DRAWINGS**

**EMERSON POWER TRANSMISSION FACILITY
ITHACA, NEW YORK**

PREPARED FOR

EMERSON POWER TRANSMISSION

D

<p>REVISIONS</p> <table border="1"> <tr> <th>NO.</th> <th>DATE</th> <th>DESCRIPTION</th> </tr> <tr> <td> </td> <td> </td> <td> </td> </tr> <tr> <td> </td> <td> </td> <td> </td> </tr> <tr> <td> </td> <td> </td> <td> </td> </tr> </table>		NO.	DATE	DESCRIPTION									
NO.	DATE	DESCRIPTION											
<p>DATE</p>	<p>SCALE</p>												
<p>DESIGNED BY: SKP</p> <p>CHECKED BY: AK</p> <p>APPROVED BY: AK</p> <p><small>EMERSON POWER TRANSMISSION, ITHACA, NY, IS THE OWNER OF THIS PROJECT. THE DESIGN OF THIS PROJECT IS THE PROPERTY OF WSP ENGINEERING OF NEW YORK, P.C. AND IS NOT TO BE REPRODUCED OR TRANSMITTED IN ANY FORM OR BY ANY MEANS, ELECTRONIC OR MECHANICAL, INCLUDING PHOTOCOPYING, RECORDING, OR BY ANY INFORMATION STORAGE AND RETRIEVAL SYSTEM, WITHOUT THE WRITTEN PERMISSION OF WSP ENGINEERING OF NEW YORK, P.C.</small></p>	<p>DATE</p>												
<p>TITLE SHEET</p> <p>EMERSON POWER TRANSMISSION ITHACA, NEW YORK PREPARED FOR EMERSON POWER TRANSMISSION</p>													
<p>WSP Engineering of New York, P.C. 2380 Sweet Home Road, Suite 3 Auburn, New York, 14228 www.wspinc.com/ny</p>													
<p>SHEET 1</p> <p>Drawing Number 00003197-003</p>													

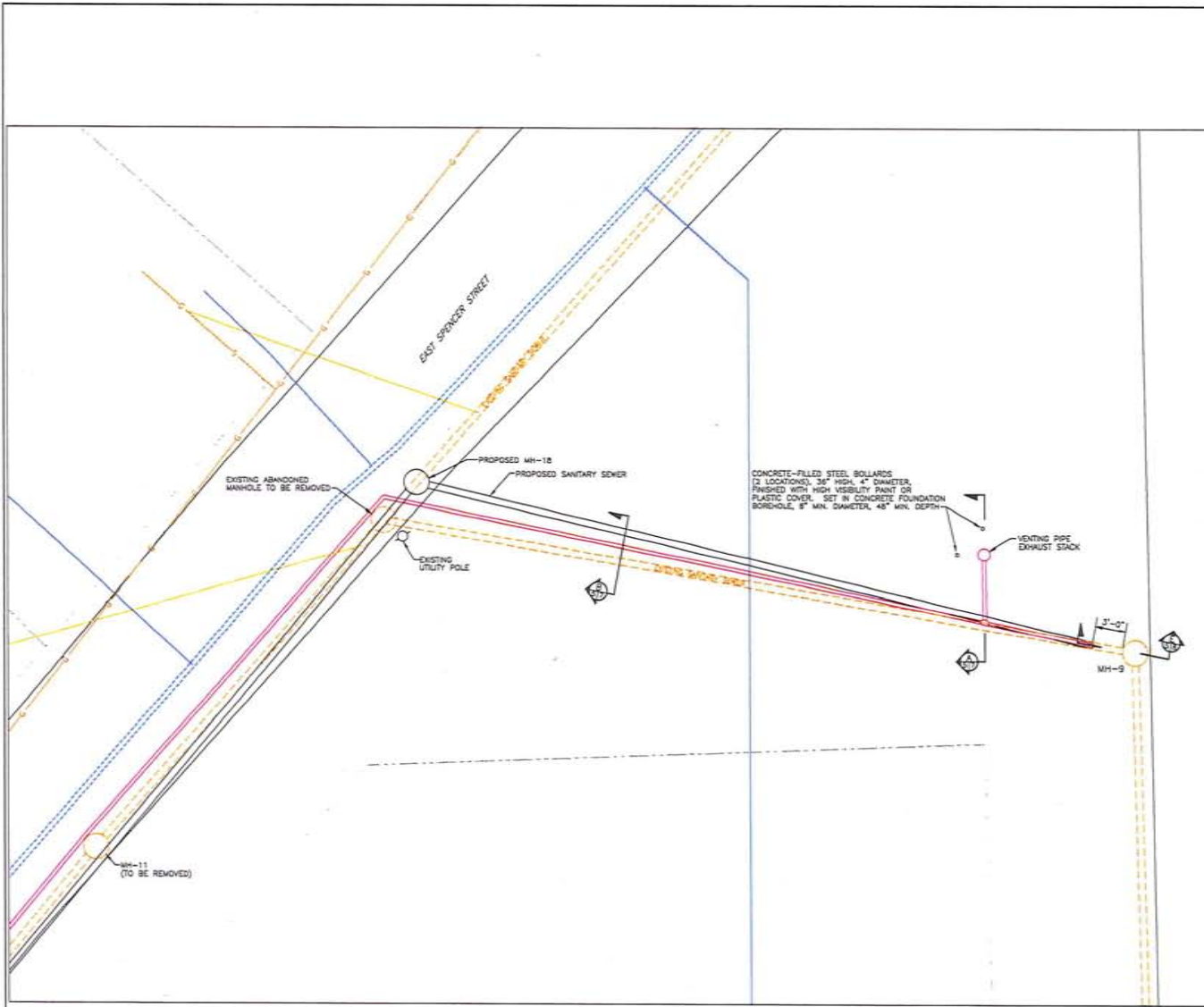

LOCATION MAP
SCALE: 1"=200'

- LEGEND**
- PROPERTY LINE
 - EXISTING SANITARY SEWER
 - EXISTING WATER LINE
 - EXISTING NATURAL GAS LINE
 - EXISTING SANITARY SEWER LATERAL (SIZE UNKNOWN)
 - VENTING PIPE
 - SECTION DESIGNATION
 - SHEET SECTION IS SHOWN SHEET CONTAINING FIRST REFERENCE

NOTES:
UTILITY INFORMATION HAS BEEN PLOTTED FROM AVAILABLE SOURCES AND THEIR LOCATIONS AND SIZE SHOULD BE CONSIDERED APPROXIMATE ONLY. THE CONTRACTOR IS RESPONSIBLE FOR DETERMINING EXACT UTILITY LOCATIONS, SIZES, AND IF UNCHARTED OR MISPLOTTED UTILITIES ARE ENCOUNTERED, THE CONTRACTOR IS REQUIRED TO NOTIFY THE OWNER IMMEDIATELY.

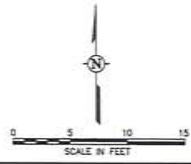

D REFERENCES:
1. SANITARY SEWER LOCATION FROM CITY OF ITHACA WATER & SEWER DEPARTMENT, SHEETS 811, 817, 134-A, 178, AND 184.
2. TOWN OF ITHACA CONTRACT DRAWING, SANITARY SEWER/SEWER REPLACEMENT SOUTH HILL, DATED APRIL 1994.

NO.	DATE	REVISIONS	DESCRIPTION
1			
2			
3			

DATE	BY	DESCRIPTION

DESIGNED BY: [Signature]
CHECKED BY: [Signature]
DATE: [Blank]

**EAST SPENCER STREET
SEWER LINE RELOCATION**
EMERSON POWER TRANSMISSION
ITHACA, NEW YORK
EMERSON POWER TRANSMISSION

WSP Engineering of New York, P.C.
2310 Sweet Home Road, Suite 3
Auburn, New York 14228
(716) 691-6232
www.wspengineering.com/usa

SHEET 6
Drawing Number
0003197-007



- LEGEND**
- - - PROPERTY LINE
 - - - EXISTING SANITARY SEWER
 - - - EXISTING STORM WATER LINE
 - - - EXISTING WATER LINE
 - - - EXISTING NATURAL GAS LINE
 - VACUUM EXCAVATION BELOW RETAINING WALL
 - VACUUM EXCAVATION ON EAST SPENCER STREET

NOTE:
 1. THE BEDROCK EXPOSED AT FT2 AND FT3 MADE UP THE OUTER LIMITS OF THE EXISTING SEWER LINE TRENCH. THEREFORE, ONE FOOT OF BEDROCK WAS UNCOVERED WITHOUT REMOVAL OF BEDROCK.

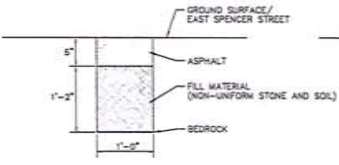

TP1 SECTION VIEW
 SCALE: 1"=1'-0"

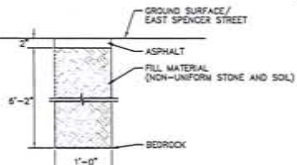

TP2 SECTION VIEW
 SCALE: 1"=1'-0"

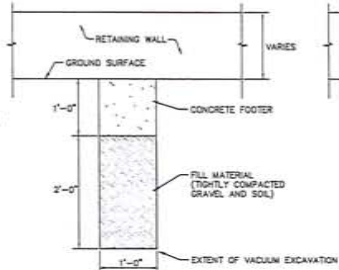

FT1 SECTION VIEW
 SCALE: 1"=1'-0"

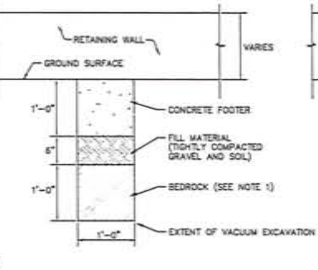

FT2 SECTION VIEW
 SCALE: 1"=1'-0"

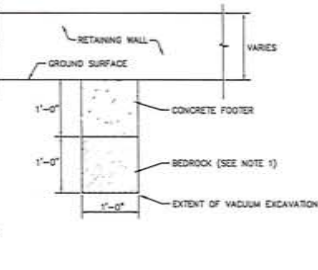

FT3 SECTION VIEW
 SCALE: 1"=1'-0"

D

REFERENCES:
 1. SANITARY SEWER LOCATION FROM CITY OF ITHACA WATER & SEWER DEPARTMENT, SHEETS 611, 617, 104-A, 170, AND 199.
 2. TOWN OF ITHACA CONTRACT CHANGE, SANITARY SEWER/STORM WATER REPLACEMENT SOUTH HILL, DATED APRIL 1994.

THE ORIGINAL VERSION OF THIS DRAWING IS IN COLOR. BLACK AND WHITE COPIES MAY NOT ACCURATELY REFLECT COLOR INFORMATION.

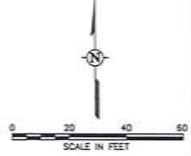

REV	DATE	BY	CHK	APP	DESC

DRAWN BY: E. COO CHECKED BY: SKP APPROVED BY: AK	PROJECT NO.: 08/07/2011 SHEET NO.: 08/07/2011 PROJECT: EMERSON POWER TRANSMISSION ITHACA, NEW YORK PREPARED FOR: EMERSON POWER TRANSMISSION PROJECT MANAGER: J. J. JONES PROJECT ENGINEER: J. J. JONES PROJECT SUPERVISOR: J. J. JONES PROJECT ASSISTANT: J. J. JONES
--	--

PRE-DESIGN VACUUM EXCAVATION

EMERSON POWER TRANSMISSION
 ITHACA, NEW YORK
 PREPARED FOR
 EMERSON POWER TRANSMISSION

WSP
Engineering of
New York, P.C.
 2800 Sweet Home Road, Suite 3
 Amherst, New York 14228
 www.wsp.com/usa

SHEET 3

Drawing Number
00003197-005

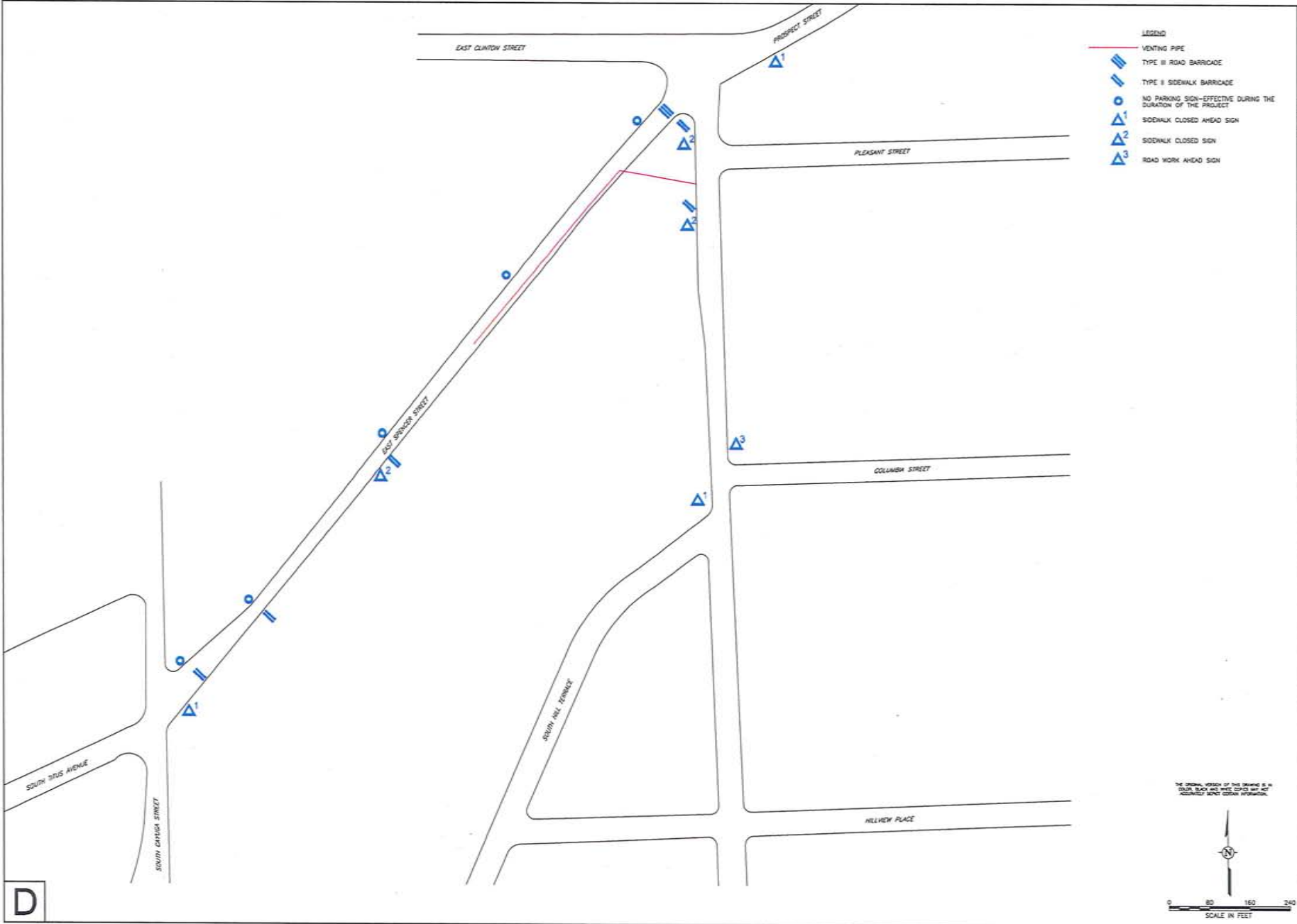

- LEGEND**
- VENTING PIPE
 - TYPE II ROAD BARRICADE
 - TYPE II SIDEWALK BARRICADE
 - NO PARKING SIGN—EFFECTIVE DURING THE DURATION OF THE PROJECT
 - SIDEWALK CLOSED AHEAD SIGN
 - SIDEWALK CLOSED SIGN
 - ROAD WORK AHEAD SIGN



REVISIONS

REV	DATE	DESCRIPTION

DATE _____

DATE: 5/17/2021
 APPROVED: [Signature]
 PROJECT: 201902021

THESE REVISIONS HAVE BEEN MADE TO THE ORIGINAL PLAN. THE ORIGINAL PLAN IS THE BASIS FOR THE DESIGN. THE DESIGNER IS NOT RESPONSIBLE FOR THE ACCURACY OF THE INFORMATION PROVIDED BY OTHER SOURCES. THE USER OF THIS PLAN SHALL BE RESPONSIBLE FOR VERIFYING THE ACCURACY OF ALL INFORMATION PROVIDED BY OTHER SOURCES.

ROAD AND SIDEWALK CLOSURE PLAN

EMERSON POWER TRANSMISSION
 ITHACA, NEW YORK
 EMERSON POWER TRANSMISSION

WSP Engineering of New York, P.C.
 2940 Sweet Home Road, Suite 3
 Amherst, New York 14228
 (716) 691-6232
www.wspenvironmental.com/usa

SHEET 4
 Drawing Number
00003197-006

D

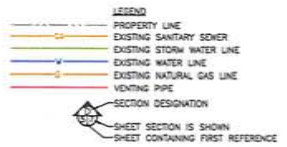
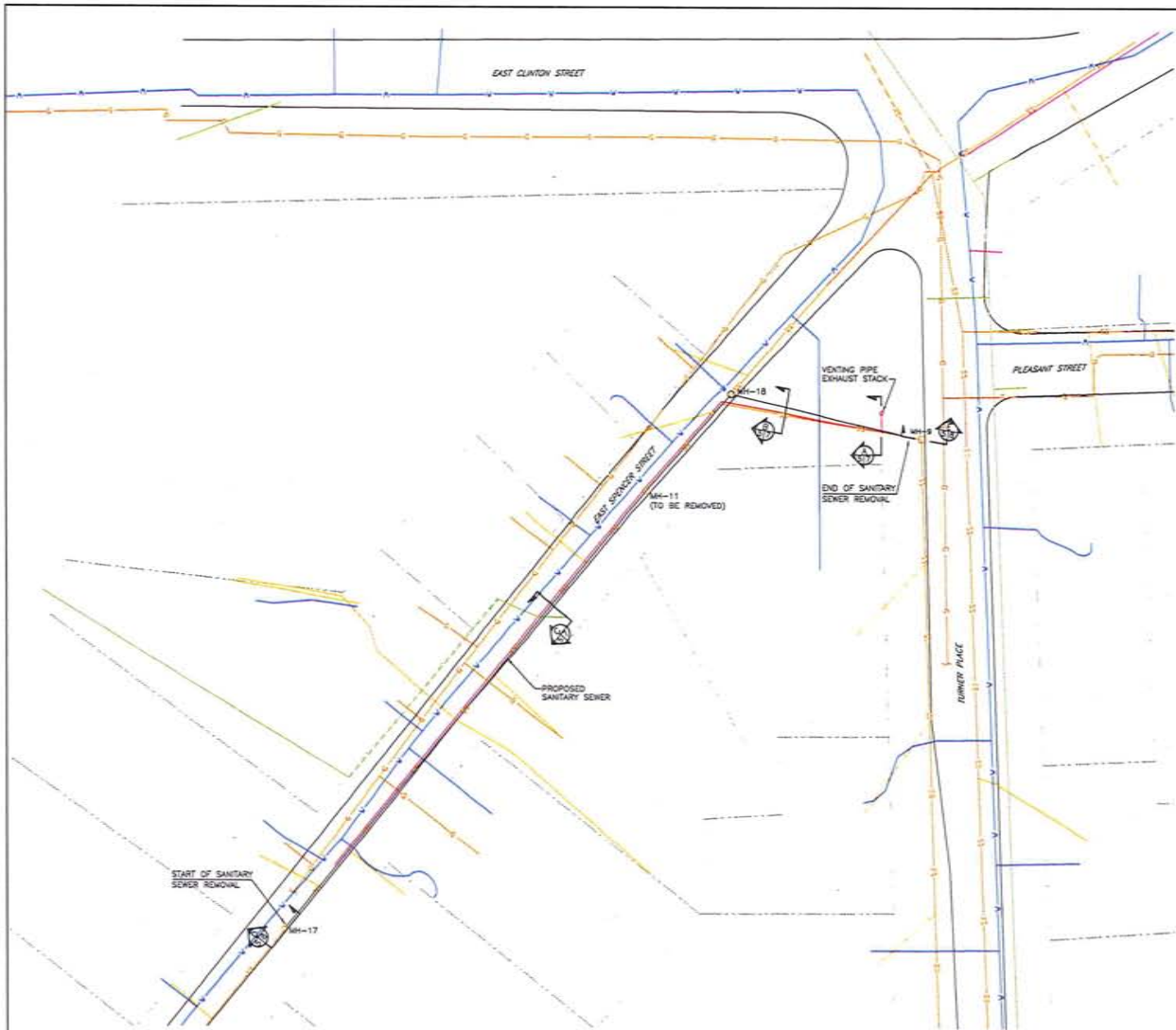

NOTES:
 UTILITY INFORMATION HAS BEEN PLOTTED FROM AVAILABLE SOURCES AND THEIR LOCATIONS AND SIZE SHOULD BE CONSIDERED APPROXIMATE ONLY. THE CONTRACTOR IS RESPONSIBLE FOR DETERMINING EXACT UTILITY LOCATIONS, SIZES, AND IF UNCHARTED OR MISPLOTTED UTILITIES ARE ENCOUNTERED, THE CONTRACTOR IS REQUIRED TO NOTIFY THE OWNER IMMEDIATELY.

MANHOLE ID	ELEVATION (FEET)		
	MANHOLE COVER	SEWER PIPE-ENTRANCE INVERT	SEWER PIPE-EXIT INVERT
MW-9	444.111	436.351	436.171
MW-11	425.911	419.77	419.77
MW-17	421.678	415.356	412.058

NOTES:
 1. ELEVATIONS WERE PROVIDED BY THE CITY OF ITHACA DEPARTMENT OF PUBLIC WORKS.
 2. MW-17 IS A VERTICAL DROP MANHOLE.

REVISIONS	
REV	DESCRIPTION
1	
2	
3	
4	
5	
6	
7	
8	
9	
10	
11	
12	
13	
14	
15	
16	
17	
18	
19	
20	
21	
22	
23	
24	
25	
26	
27	
28	
29	
30	
31	
32	
33	
34	
35	
36	
37	
38	
39	
40	
41	
42	
43	
44	
45	
46	
47	
48	
49	
50	
51	
52	
53	
54	
55	
56	
57	
58	
59	
60	
61	
62	
63	
64	
65	
66	
67	
68	
69	
70	
71	
72	
73	
74	
75	
76	
77	
78	
79	
80	
81	
82	
83	
84	
85	
86	
87	
88	
89	
90	
91	
92	
93	
94	
95	
96	
97	
98	
99	
100	

300-FOOT VENTING SYSTEM LAYOUT

EMERSON POWER TRANSMISSION
 ITHACA, NEW YORK

Prepared from
EMERSON POWER TRANSMISSION

WSP Engineering of New York, P.C.
 2300 Sweet Home Road, Suite 3
 Arden, New York 14228
 (716) 691-5232
 www.wspenvironmental.com/usa

SHEET 5

Drawing Number
00003197-005

D REFERENCES:
 1. SANITARY SEWER LOCATION FROM CITY OF ITHACA WATER & SEWER DEPARTMENT, SHEETS 917, 917, 154-A, 176, AND 184.
 2. TOWN OF ITHACA CONTRACT DRAWING, SANITARY SEWER/RAIN REPLACEMENT SOUTH HILL, DATED APRIL 1994.

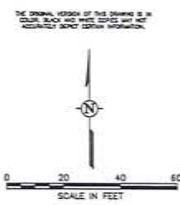

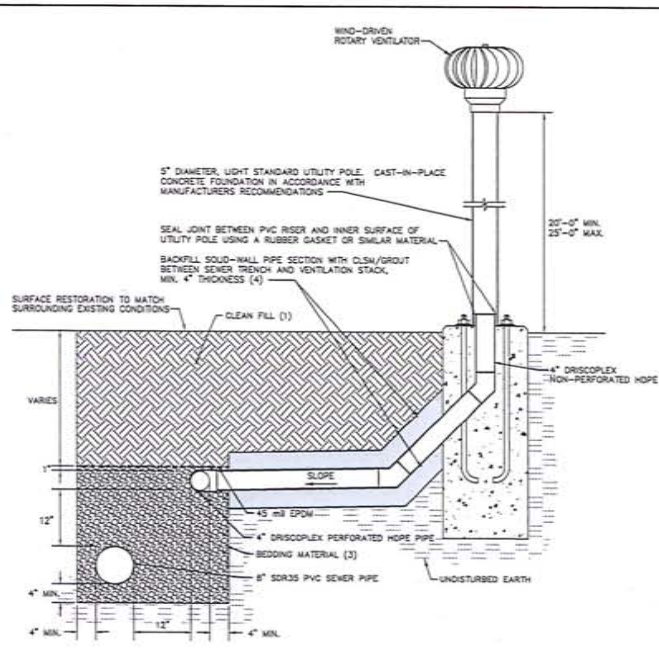

A EXHAUST STACK DETAIL
SCALE: 1"=1'-0"

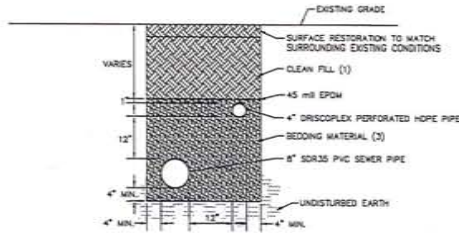

B SECTION B DETAIL
SCALE: 3/4"=1'-0"

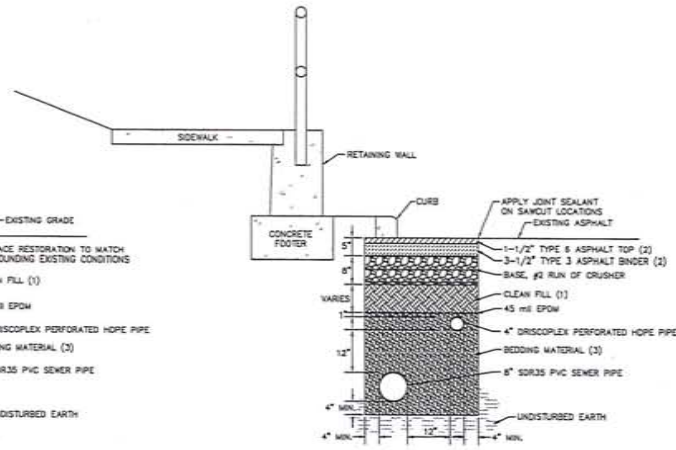

C SECTION C DETAIL
SCALE: 3/4"=1'-0"

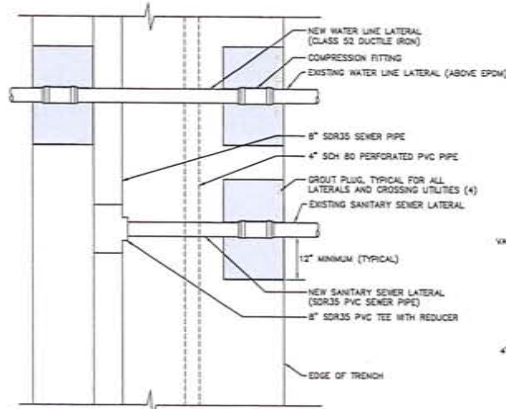

D TYPICAL WATER AND SANITARY SEWER LATERALS - PLAN VIEW
NOT TO SCALE

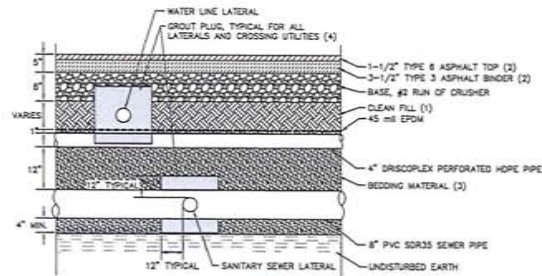

E SECTION VIEW
NOT TO SCALE

NOTES

- CLEAN FILL SHALL BE DEFINED AS IMPORTED MATERIAL MEETING ASTM 2487 SOIL CLASSIFICATION GROUPS GW, GP, GM, SW, SP, AND SM, OR A COMBINATION OF THESE GROUPS, FREE OF ROCK OR GRAVEL LARGER THAN 2 INCHES IN ANY DIMENSION, DEBRIS, WASTE, FROZEN MATERIALS, VEGETATION, AND OTHER DISTURBING MATERIAL, AND ALL OTHER SOILS THAT ENGINEER OR EXCAVATED MATERIAL MEETING THE ABOVE REQUIREMENTS AND DEEMED SATISFACTORY BY ENGINEER. COMPACT ASPHALT IN ACCORDANCE WITH NYSDOT STANDARD SPECIFICATION SECTION 403-3.03; COMPACTION.
- BEDDING MATERIAL SHALL BE TYPE 1 OR TYPE 1A, OPEN GRADE, CLEAN AGGREGATE (ASTM D2487); COMPACTED TO 95% STANDARD PROCTOR DENSITY.
- GROUT PLUG AND BACKFILL SHALL BE CONSTRUCTED USING CONTROLLED LOW STRENGTH MATERIAL (CLSM) MEETING THE REQUIREMENTS OF NYSDOT STANDARD SPECIFICATION SECTION 204; CONTROLLED LOW STRENGTH MATERIAL, WITH 5% BENTONITE ADDITIVE.

SECTION DESIGNATION

- A** SHEET SECTION IS SHOWN
- B** SHEET CONTAINING FIRST REFERENCE

REVISIONS	DESCRIPTION

DATE	BY	CHKD	APP'D	DESC

DATE	BY	CHKD	APP'D	DESC

SITE WORK DETAILS

EMERSON POWER TRANSMISSION
ITHACA, NEW YORK
PREPARED FOR
EMERSON POWER TRANSMISSION

WSP Engineering of New York, P.C.
2310 Sweet Home Road, Suite 3
Anchorage, New York 14228
(716) 851-5522
www.wspengineering.com/usa

- NOTES
- CLEAN FILL SHALL BE DEFINED AS IMPORTED MATERIAL MEETING ASTM 2487 SOIL CLASSIFICATION GROUPS GM, GP, GM, SM, SP, AND SM, OR A COMBINATION OF THESE GROUPS, FREE OF ROCK OR GRAVEL LARGER THAN 2 INCHES IN ANY DIMENSION, DEBRIS, WASTE, FROZEN MATERIALS, VEGETATION, AND OTHER DELETERIOUS MATTER, AND ALL OTHER SOILS THAT ENGINEER, OR EXCAVATED MATERIAL MEETING THE ABOVE REQUIREMENTS AND DEEMED SATISFACTORY BY ENGINEER. COMPACT ASPHALT IN ACCORDANCE WITH NYSDOT STANDARD SPECIFICATION SECTION 403-3.03 COMPACTION
 - SOILING MATERIAL SHALL BE TYPE 1 OR TYPE 1A, OPEN GRADED, CLEAN AGGREGATE (ASTM D2487) COMPACTED TO 95% STANDARD PROCTOR DENSITY
 - GROUT PLUG AND BACKFILL SHALL BE CONSTRUCTED USING CONTROLLED LOW STRENGTH MATERIAL (CLSM) MEETING THE REQUIREMENTS OF NYSDOT STANDARD SPECIFICATION SECTION 204: CONTROLLED LOW STRENGTH MATERIAL, WITH 5% BENTONITE ADDITIVE.

D SECTION DESIGNATION
VIS SHEET SECTION IS SHOWN
 SHEET CONTAINING FIRST REFERENCE

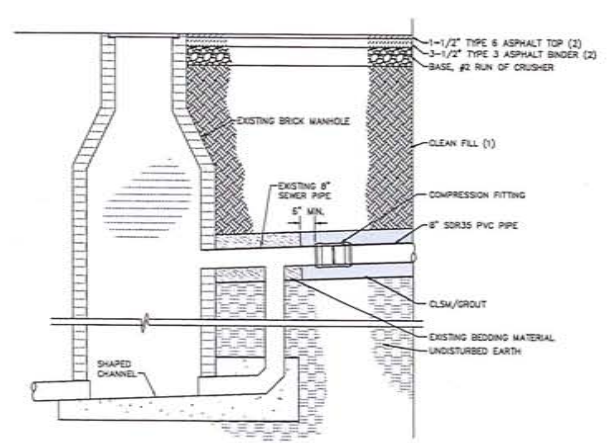

D MH-17 CONNECTION DETAIL
 3/8" NOT TO SCALE

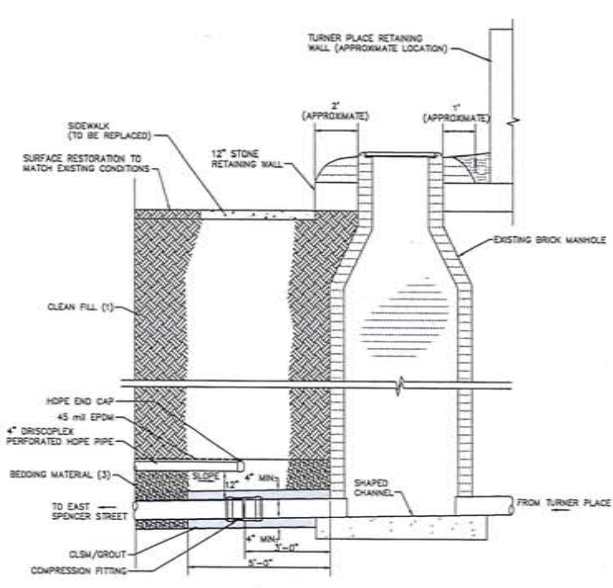

E MH-8 CONNECTION DETAIL
 3/8" NOT TO SCALE

REV	DESCRIPTION	DATE

DATE	BY	CHKD	APPD

MANHOLE CONNECTION DETAILS
 EMERSON POWER TRANSMISSION
 ITHACA, NEW YORK
 PREPARED FOR
 EMERSON POWER TRANSMISSION



 WSP Engineering of New York, P.C.
 2300 Sweet Home Road, Suite 3
 Ardenheath, NY 14820
 (716) 891-6252
 www.wspenvironmental.com/usa

D

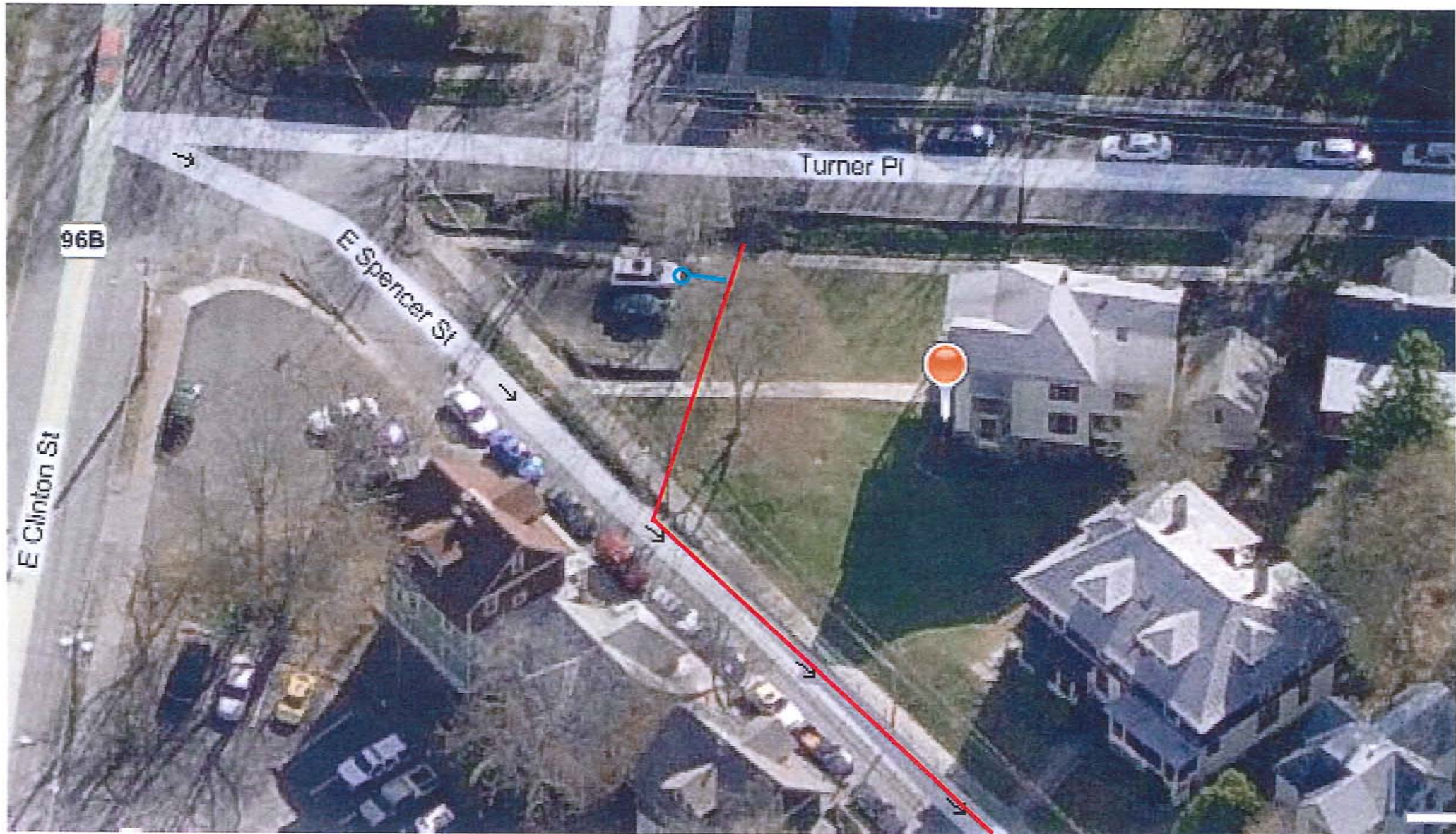

GIS Viewer - 5/16/2011



- Legend**
c 08430-886 06 - 04500 c- of 2007
- Border
 - Historic Property (not in district)
 - Historic District
 - Commons Detail
 - Park Names
 - Parks
 - Properties
 - Roads
 - Property Address
 - Waterway



The geographic data represented has been developed from various public records and data sources. Users of this mapping application are hereby notified that the aforementioned public primary information sources should be consulted for verification of the information contained on this website. While efforts have been made to use the most current and accurate data, Tompkins County assumes no legal responsibility for the information contained in this internet-based Geographic Information System. User assumes all risks and responsibility for determining whether this map is sufficient for purposes intended.



FOR TAX PURPOSES ONLY
NOT TO BE USED FOR CONVEYANCE

All lot maps are referenced to the New York State Plane Central Coordinate System using the NAD 83 North American Datum. Property lines have been digitized as of 2011. All Township Census Tracts & Precincts have been digitized as of 2011. All lot numbers and acreages may vary from legal descriptions. For complete legal descriptions or concerns, please refer to the appropriate deed and/or plat.

NOTICE OF DISCLAIMER
The City of Ithaca is not responsible for any errors or omissions in this map. The City of Ithaca is not responsible for any errors or omissions in this map. The City of Ithaca is not responsible for any errors or omissions in this map.

SPECIAL DISTRICT INFORMATION
This map shows the following special districts:
City of Ithaca
City of Ithaca
City of Ithaca

- Building Footprint (1991-2009)
- Curb/Parade Line
- Railroad
- Hydrography
- Special District
- Municipality
- Military Tract/Widens & Flot Lot Number

- LEGEND**
- Parcel Connector
 - Property Line
 - Former Property Line
 - Current Year Change
 - Block Limit
 - External Tax Map
 - Block Number

- 43.1 Parcel Lot Number
- 1.0 Previous Lot Number
- 4.4 Subdivision Lot Number
- 3.8 Ac Deed/Survey Acreage
- 2.11 Ac C Completed Acreage
- 18.50 Ac D Grouped (Total) Acreage
- 300.0 Stated (Calculated) Acreage
- 300.0 Deed Dimension

CITY OF ITHACA
TOWNSHIP COUNTY, N.Y.

MAP: 81
SCALE: 1" = 75'
DATE: 12/15/2011
MAP REVISED: 12/15/2011
MAP PRINTED: 12/15/2011